

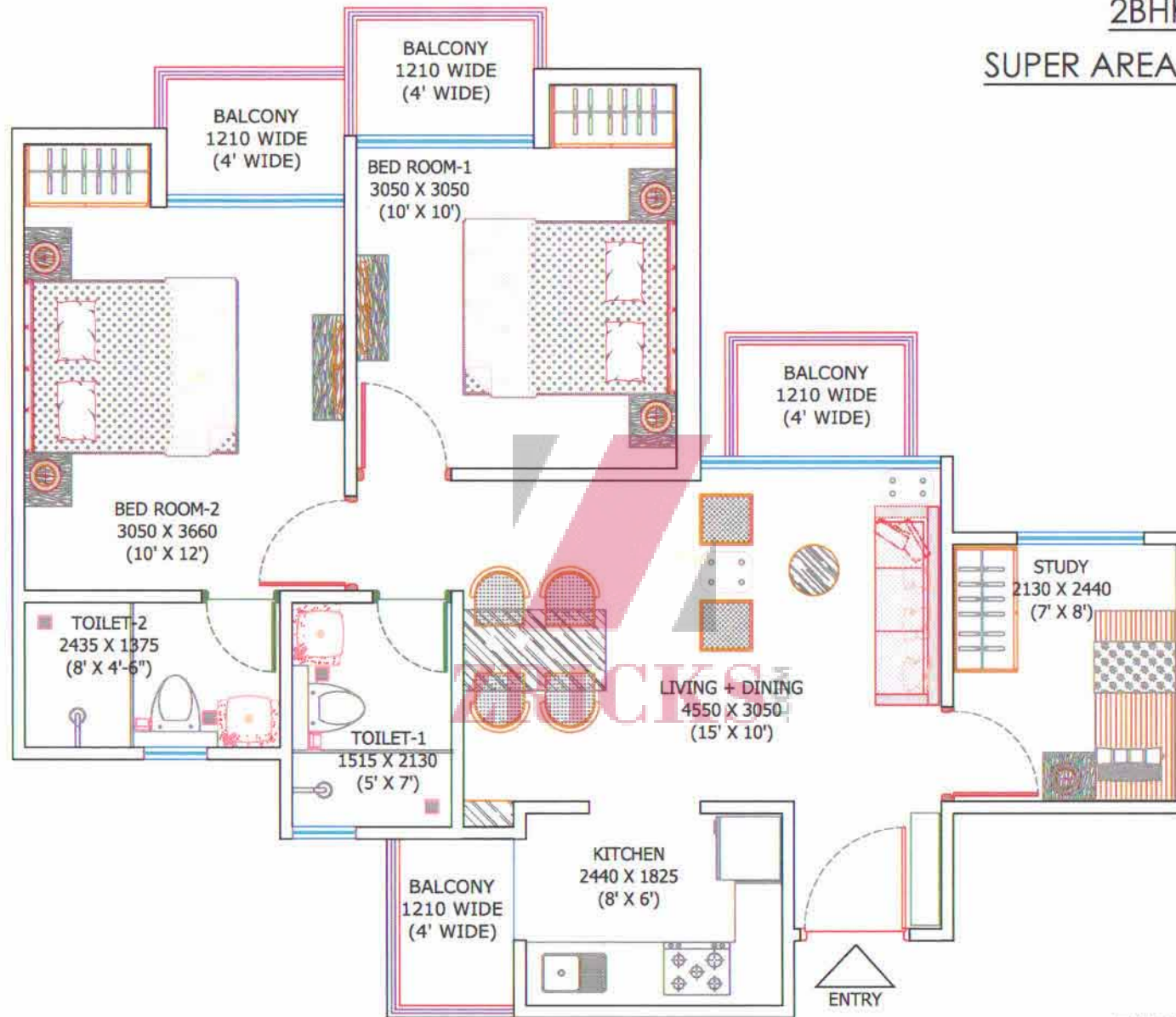



2BHK +STUDY+ 2TOILET
SUPER AREA = 995 SQ FT AREA



TENTATIVE UNIT PLAN SUBJECT TO CHANGE

AJNARA - UNIT PLAN- 2BHK+STUDY+2TOILET FOR SPORTS CITY AT GRT
NOIDA

Architect
Hafeez
Contractor

2BHK + 2TOILET
SUPER AREA = 895 SQ FT AREA

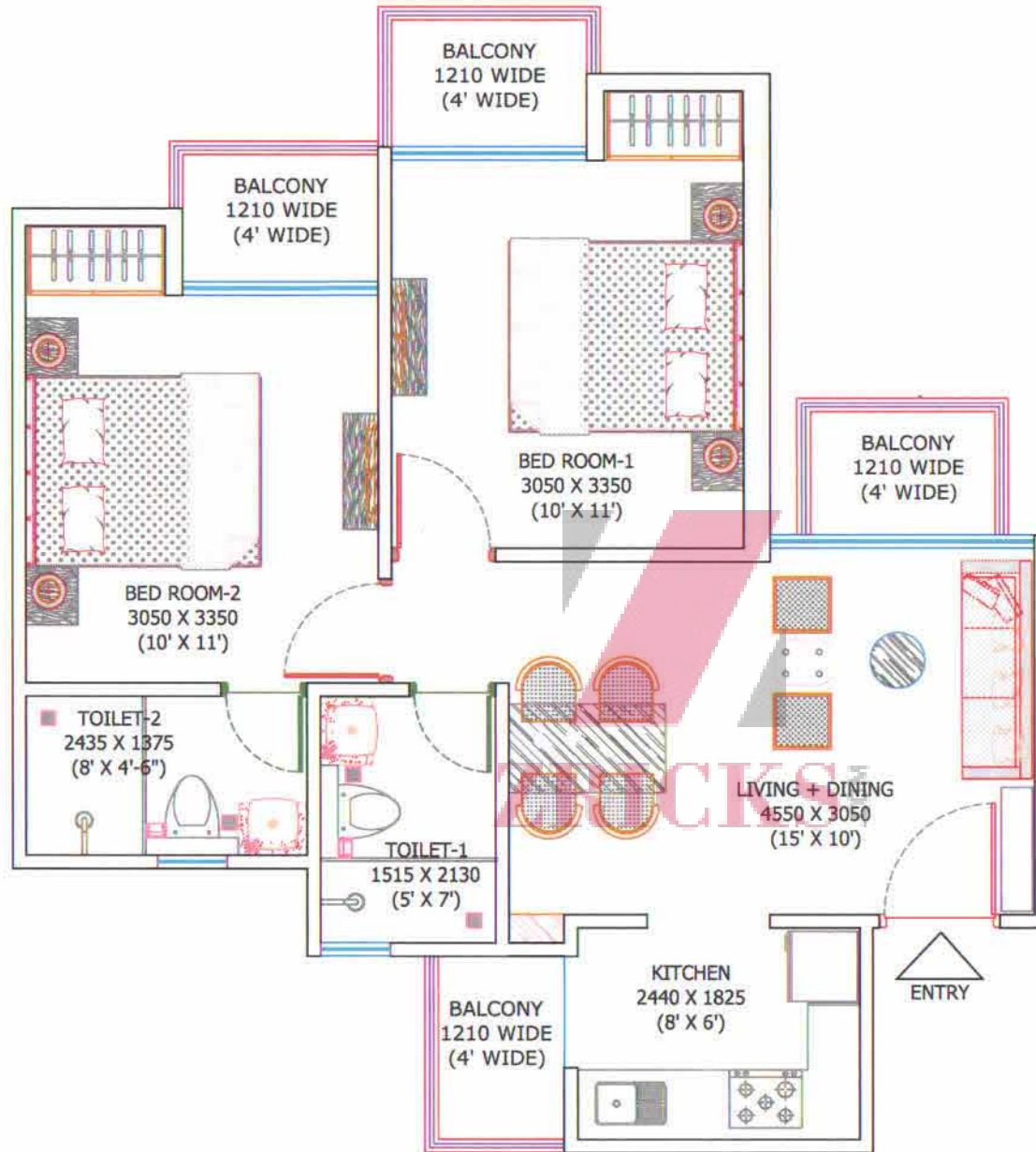

TENTATIVE UNIT PLAN SUBJECT TO CHANGE

AJNARA - UNIT PLAN- 2BHK+2TOILET FOR SPORTS CITY AT GRT NOIDA

Architect
Hafeez
Contractor

3BHK + 3TOILET
SUPER AREA = 1195 SQ FT AREA

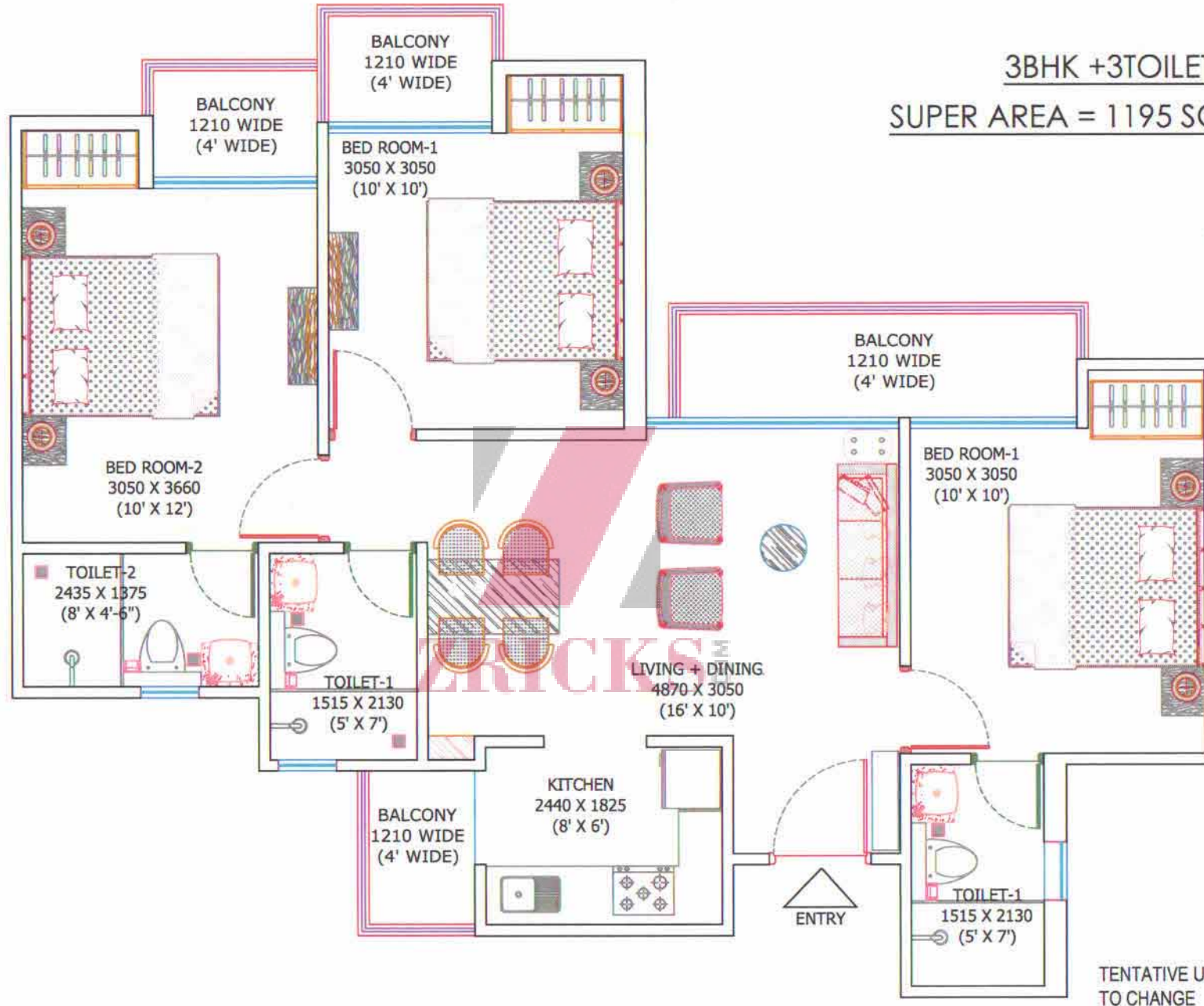

TENTATIVE UNIT PLAN SUBJECT TO CHANGE

AJNARA - UNIT PLAN- 3BHK+3TOILET FOR SPORTS CITY AT GRT NOIDA

Architect
Hafeez
Contractor

3 BHK + 3 TOI + DRESS
SUPER AREA = 1375 SQ. FT.

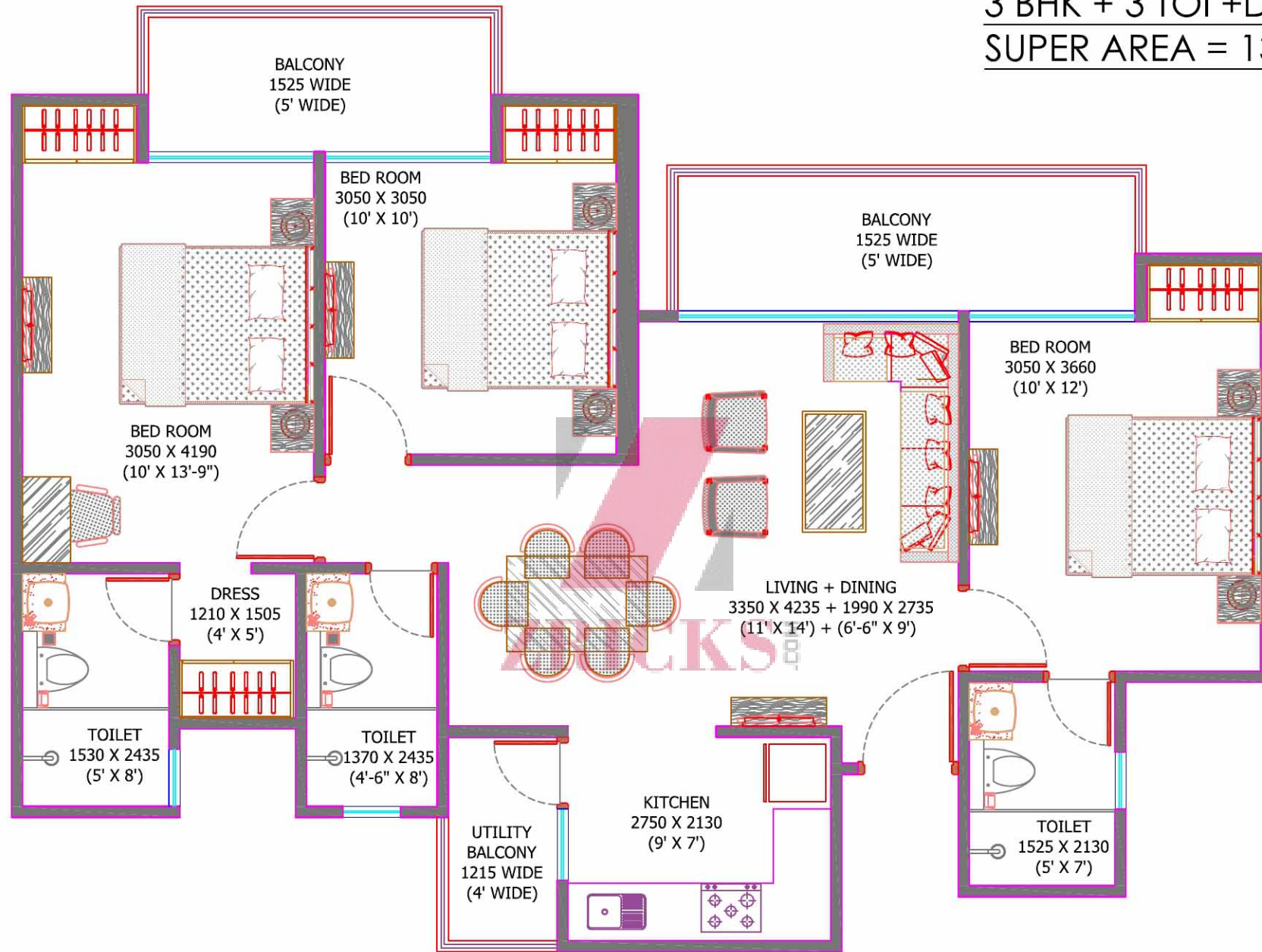

TENTATIVE UNIT PLAN SUBJECT TO CHANGE

AJNARA CITY AT GREATER NOIDA

Architect
Hafeez
Contractor

LEGEND:-

| TOWER | TYPE | SALE AREA |
|---------|---------------|-----------|
| A, B | 2 BHK | 895 SQFT |
| | 3 BHK REGULAR | 1195 SQFT |
| C, P | 2.5 BHK | 995 SQFT |
| | 3 BHK REGULAR | 1195 SQFT |
| D, Q, R | 3 BHK REGULAR | 1195 SQFT |
| | 3 BHK LUXURY | 1395 SQFT |

